

- NOTES:**
- ADJUST EXISTING MANHOLES AS REQUIRED.
  - ADJUST EXISTING WATER VALVES AS REQUIRED.
  - FOR CB'S, LEADS AND UNDERGROUND INFO, SEE SHEETS 48 & 49.
  - INSTALL 18m OF SUBDRAIN EACH SIDE OF LOW POINTS AS PER SD-245 c/w CAPPED ENDS.
  - PRIVATE APPROACHES ARE 200mm REINFORCED CONCRETE WITH 75mm BASE COURSE, 225mm-50mm SUB-BASE AND NON-WOVEN GEOTEXTILE.
  - BULLNOSES, APPROACHES AND INTERSECTION RADII ARE TO BE INTEGRAL MODIFIED BARRIER CURB.
  - MEDIAN IS TO BE FULLY BOULEVARD GRADED AND FINISH WITH TOP SOIL AND SOD.
  - EXISTING MONITORING WELLS FROM TUNNEL INSTALLATION TO BE REMOVED DURING EXCAVATION. CONTRACT ADMINISTRATOR TO MARK OUT FOR CLARITY.

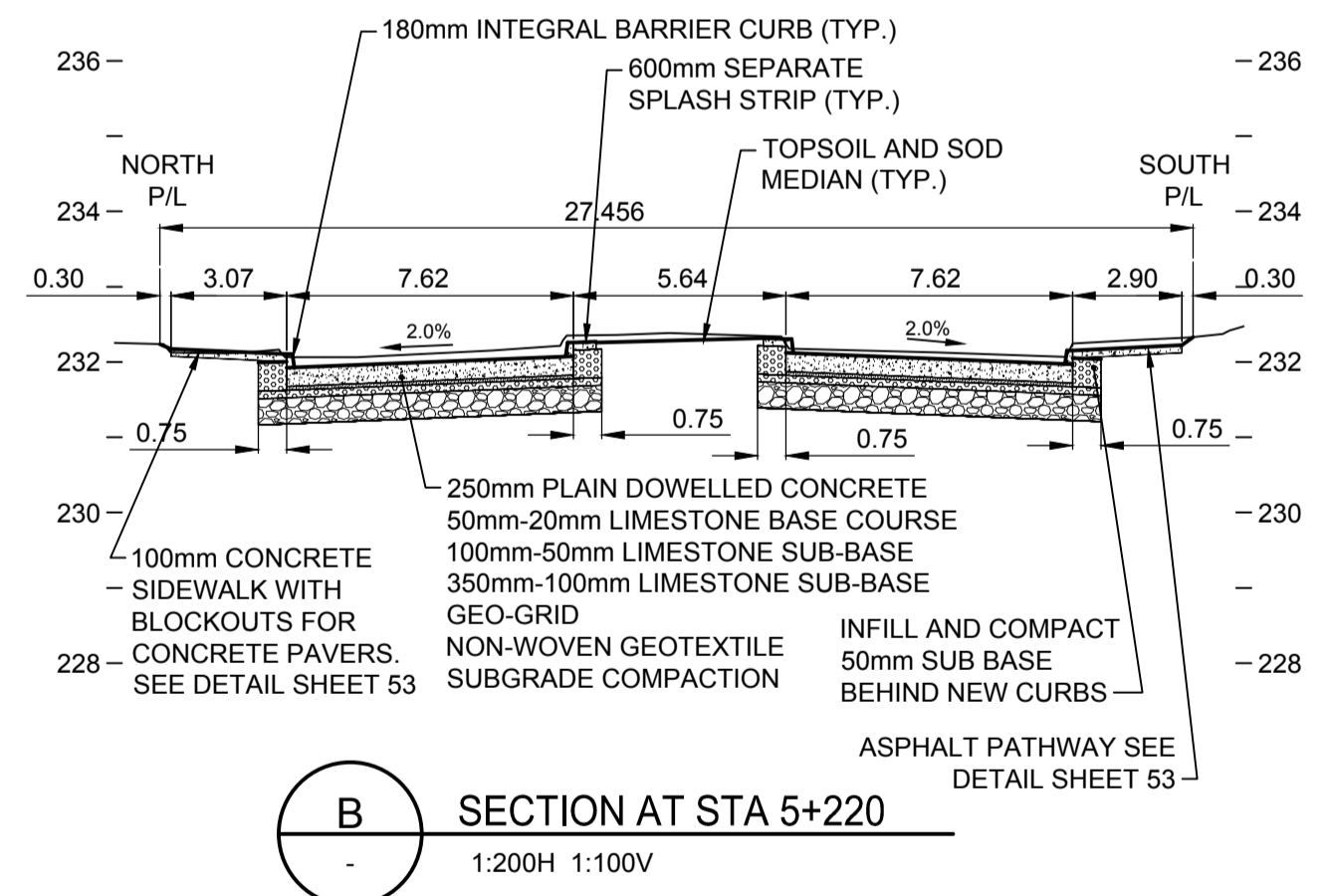
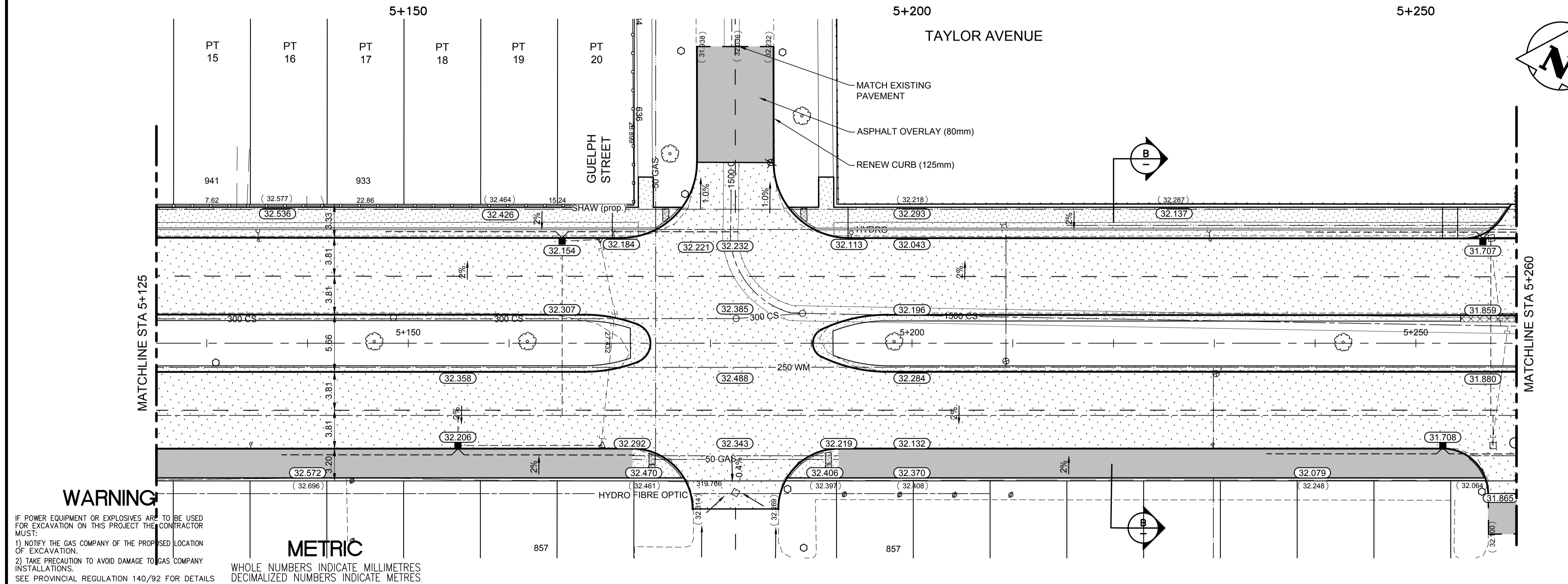

**WARNING**  
IF POWER EQUIPMENT OR EXPLOSIVES ARE TO BE USED FOR EXCAVATION ON THIS PROJECT THE CONTRACTOR MUST:  
1) NOTIFY THE GAS COMPANY OF THE PROPOSED LOCATION OF EXCAVATION.  
2) TAKE PRECAUTION TO AVOID DAMAGE TO GAS COMPANY INSTALLATIONS.  
SEE PROVINCIAL REGULATION 140/92 FOR DETAILS

**METRIC**  
WHOLE NUMBERS INDICATE MILLIMETRES  
DECIMALIZED NUMBERS INDICATE METRES

| EXISTING             | PROPOSED             | EXISTING            | PROPOSED            | EXISTING             | PROPOSED | LEGEND-PROFILE | PROPOSED |
|----------------------|----------------------|---------------------|---------------------|----------------------|----------|----------------|----------|
| 150 WM               | 150 WM               | HYDRO               | HYDRO               | 3 PROFILE            |          |                |          |
| HYDRANT              | HYDRANT              | M.T.S.              | M.T.S.              | NORTH OR WEST GUTTER |          |                |          |
| VALVE                | VALVE                | CONCRETE            | CONCRETE            | SOUTH OR EAST GUTTER |          |                |          |
| 300 LDS              | 300 LDS              | ASPHALT             | ASPHALT             | NORTH MEDIAN GUTTER  |          |                |          |
| 250 WWS              | 250 WWS              | WASTEWATER SEWER    | WASTEWATER SEWER    | SOUTH MEDIAN GUTTER  |          |                |          |
| MANHOLE              | MANHOLE              | ASPHALT MILL & FILL | ASPHALT MILL & FILL | NORTH OR WEST P.L.   |          |                |          |
| CATCH BASIN          | CATCH BASIN          | STREET LIGHT        | STREET LIGHT        | SOUTH OR EAST P.L.   |          |                |          |
| CURB INLET/CATCH PIT | CURB INLET/CATCH PIT | HYDRO POLE          | HYDRO POLE          |                      |          |                |          |
| TRANSIT STOP         | TRANSIT STOP         | SURVEY BAR          | SURVEY BAR          |                      |          |                |          |
| GAS                  | GAS                  | ELEVATION           | ELEVATION           |                      |          |                |          |
| PROPERTY LINE        | PROPERTY LINE        | SIDEWALK RAMP       | SIDEWALK RAMP       |                      |          |                |          |
| LEGEND-PLAN          | LEGEND-PLAN          |                     |                     |                      |          |                |          |

**LOCATION APPROVED UNDERGROUND STRUCTURES**  
SUPV. U/G STRUCTURES COMMITTEE DATE  
NOTE: LOCATION OF UNDERGROUND STRUCTURES AS SHOWN ARE BASED ON THE BEST INFORMATION AVAILABLE BUT NO GUARANTEE IS GIVEN THAT ALL EXISTING UTILITIES ARE SHOWN OR THAT THE GIVEN LOCATIONS ARE EXACT. CONFIRMATION OF EXISTENCE AND EXACT LOCATION OF ALL SERVICES MUST BE OBTAINED FROM THE INDIVIDUAL UTILITIES BEFORE PROCEEDING WITH CONSTRUCTION.

| NO. | REVISIONS         | DATE     | BY     |
|-----|-------------------|----------|--------|
| 0   | ISSUED FOR TENDER | 20.02.14 | S.R.S. |

**Stantec**  
500 - 311 Portage Avenue, Winnipeg MB Canada  
www.stantec.com

|                   |                            |
|-------------------|----------------------------|
| DESIGNED BY: T.G. | CHECKED BY: R.K.H.         |
| DRAWN BY: M.K.    | APPROVED BY: S.R.S.        |
| HOR. SCALE: 1:250 | RELEASED FOR CONSTRUCTION: |
| VERTICAL: 1:10    | DATE: 2019/06/12           |

**PRELIMINARY DRAWING**  
NOT TO BE USED FOR CONSTRUCTION  
ENGINEER'S SEAL  
CONSULTANT DRAWING NO. C-234

**THE CITY OF WINNIPEG**  
PUBLIC WORKS DEPARTMENT  
ENGINEERING DIVISION

2019-2023 STAFFORD/TAYLOR/CORYDON  
TENDER 1  
TAYLOR AVENUE  
STA 5+125 TO STA 5+260  
ROADWORKS - RECONSTRUCTION

SHEET 45 OF 55  
CAD FILE DRAWING NUMBER 08020c-233-932.dwg  
CITY DRAWING NUMBER P-3525-3